

**SIDEWALK CLEARING POLICY - CURRENT POLICY (ADOPTED IN 2017)**

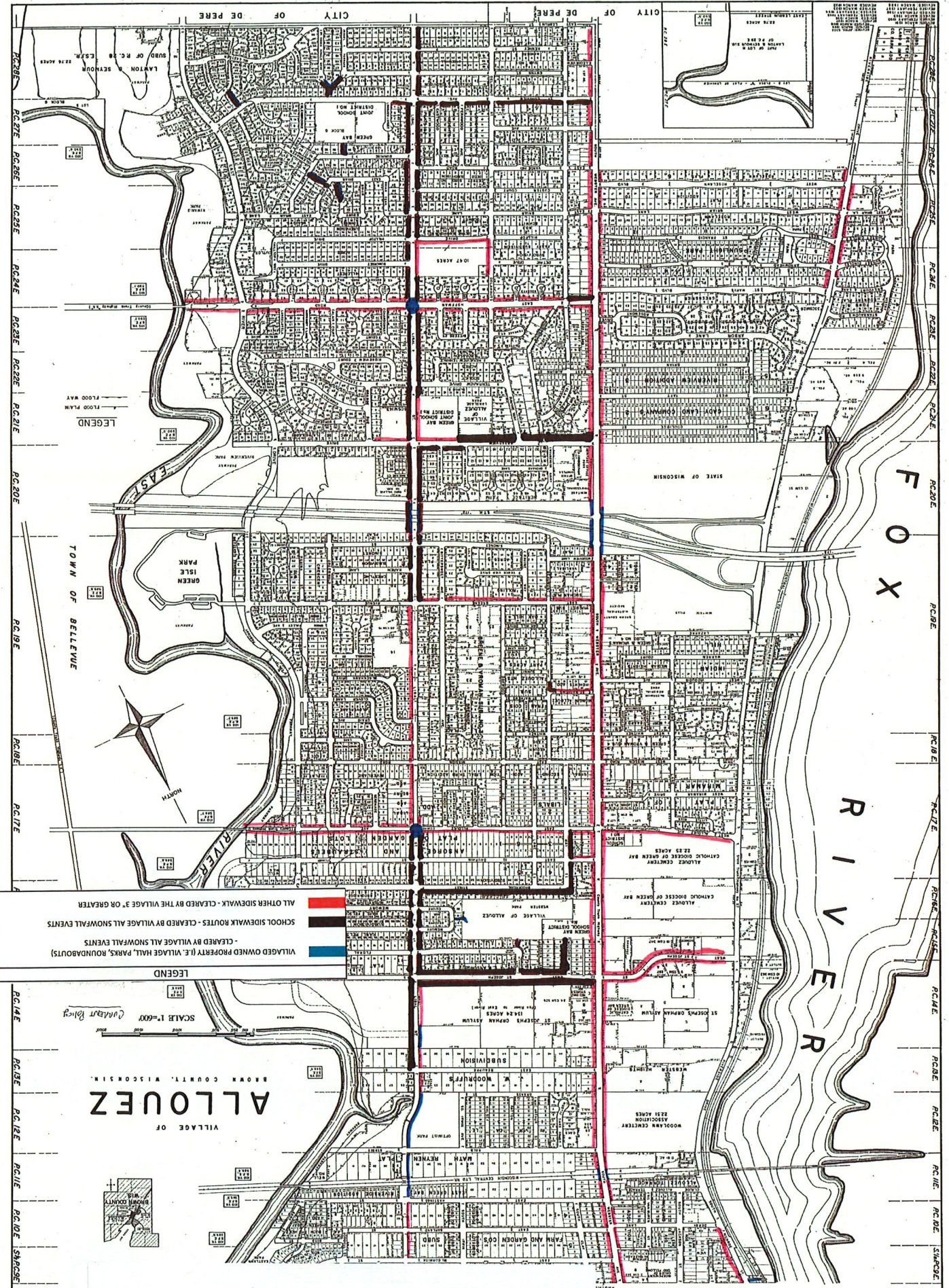

- LEGEND**
- ALL OTHER SIDEWALK - CLEARED BY THE VILLAGE 3" OR GREATER
  - SCHOOL SIDEWALK ROUTES - CLEARED BY VILLAGE ALL SNOWFALL EVENTS
  - VILLAGED OWNED PROPERTY (I.E. VILLAGE HALL, PARKS, ROUNDABOUTS) - CLEARED BY VILLAGE ALL SNOWFALL EVENTS

SCALE: 1" = 600'

Current Policy

**ALLOUEZ**

VILLAGE OF



PC.196 PC.197 PC.198 PC.199  
PC.200 PC.201 PC.202 PC.203  
PC.204 PC.205 PC.206 PC.207  
PC.208 PC.209 PC.210 PC.211  
PC.212 PC.213 PC.214 PC.215  
PC.216 PC.217 PC.218 PC.219  
PC.220 PC.221 PC.222 PC.223  
PC.224 PC.225 PC.226 PC.227  
PC.228 PC.229 PC.230 PC.231  
PC.232 PC.233 PC.234 PC.235  
PC.236 PC.237 PC.238 PC.239  
PC.240 PC.241 PC.242 PC.243  
PC.244 PC.245 PC.246 PC.247  
PC.248 PC.249 PC.250 PC.251  
PC.252 PC.253 PC.254 PC.255  
PC.256 PC.257 PC.258 PC.259  
PC.260 PC.261 PC.262 PC.263  
PC.264 PC.265 PC.266 PC.267  
PC.268 PC.269 PC.270 PC.271  
PC.272 PC.273 PC.274 PC.275  
PC.276 PC.277 PC.278 PC.279  
PC.280 PC.281 PC.282 PC.283  
PC.284 PC.285 PC.286 PC.287  
PC.288 PC.289 PC.290 PC.291  
PC.292 PC.293 PC.294 PC.295  
PC.296 PC.297 PC.298 PC.299

CITY OF GREEN BAY

STAFF RECOMMENDED SIDEWALK CLEARING POLICY

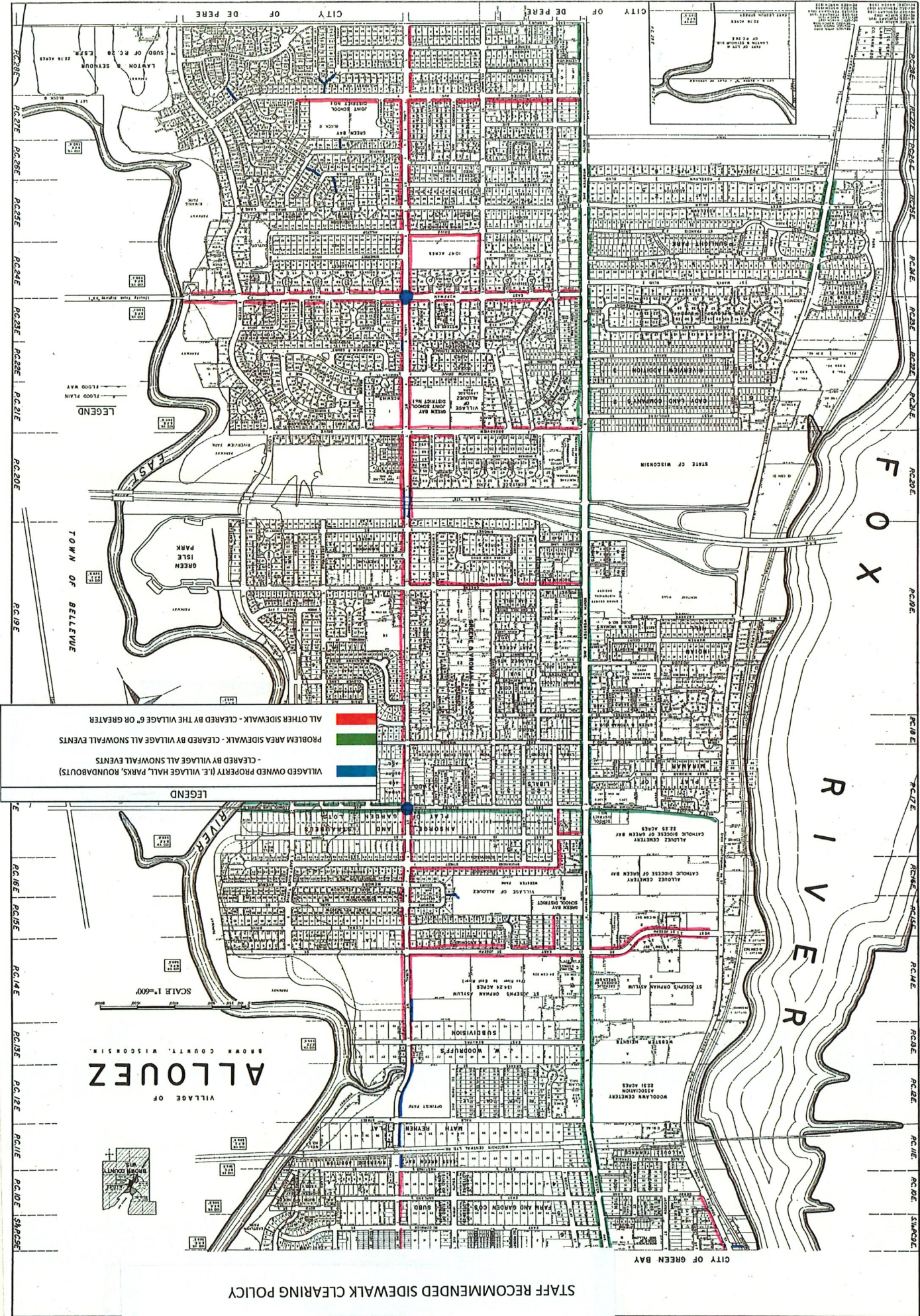

- LEGEND**
- █ ALL OTHER SIDEWALK - CLEARED BY THE VILLAGE 6' OR GREATER
  - █ PROBLEM AREA SIDEWALK - CLEARED BY VILLAGE ALL SNOWFALL EVENTS
  - █ VILLAGED OWNED PROPERTY (I.E. VILLAGE HALL, PARKS, ROUNDABOUTS) - CLEARED BY VILLAGE ALL SNOWFALL EVENTS

VILLAGE OF  
**ALLOUEZ**  
BROWN COUNTY, WISCONSIN

SCALE 1"=600'

**LEGEND**

█ FLOOD PLAIN  
█ FLOOD WAY  
█ FLOOD WAY

TOWN OF BELLEVUE

EAST RIVER

GREEN ISLE PARK

LAWTON SEYMOUR 22 1/2 ACRES  
SUDS OF F.C. 28 ESTN.

JOINT SCHOOL GREEN BAY 22 1/2 ACRES

10 1/2 ACRES

VILLAGE OWNED PROPERTY

WOLLAH CENTER 22 1/2 ACRES

ST. JOSEPH'S CATHOLIC CHURCH 22 1/2 ACRES

ALLOUEZ CENTER 22 1/2 ACRES

ALLOUEZ CENTER 22 1/2 ACRES

ALLOUEZ CENTER 22 1/2 ACRES

ALLOUEZ CENTER 22 1/2 ACRES

ALLOUEZ CENTER 22 1/2 ACRES

ALLOUEZ CENTER 22 1/2 ACRES

ALLOUEZ CENTER 22 1/2 ACRES

ALLOUEZ CENTER 22 1/2 ACRES

ALLOUEZ CENTER 22 1/2 ACRES

ALLOUEZ CENTER 22 1/2 ACRES

ALLOUEZ CENTER 22 1/2 ACRES

ALLOUEZ CENTER 22 1/2 ACRES

ALLOUEZ CENTER 22 1/2 ACRES

ALLOUEZ CENTER 22 1/2 ACRES

ALLOUEZ CENTER 22 1/2 ACRES

ALLOUEZ CENTER 22 1/2 ACRES

ALLOUEZ CENTER 22 1/2 ACRES

CITY OF GREEN BAY

STATE OF WISCONSIN

STATE OF WISCONSIN

CITY OF DE PERE

CITY OF DE PERE

CITY OF DE PERE

CITY OF DE PERE

CITY OF DE PERE

CITY OF DE PERE

CITY OF DE PERE

CITY OF DE PERE

CITY OF DE PERE

CITY OF DE PERE

CITY OF DE PERE

CITY OF DE PERE

CITY OF DE PERE

CITY OF DE PERE

CITY OF DE PERE

CITY OF DE PERE

CITY OF DE PERE

CITY OF DE PERE

CITY OF DE PERE

CITY OF DE PERE

CITY OF DE PERE

CITY OF DE PERE

CITY OF DE PERE

CITY OF DE PERE

CITY OF DE PERE

F O X R I V E R

F O X R I V E R

F O X R I V E R

F O X R I V E R

F O X R I V E R

F O X R I V E R

F O X R I V E R

F O X R I V E R

F O X R I V E R

F O X R I V E R

F O X R I V E R

F O X R I V E R

F O X R I V E R

F O X R I V E R

F O X R I V E R

F O X R I V E R

F O X R I V E R

F O X R I V E R

F O X R I V E R

F O X R I V E R

F O X R I V E R

F O X R I V E R

F O X R I V E R

F O X R I V E R

F O X R I V E R

## Sidewalk Clearing Ordinance

\*Sidewalk types described in the policies below are defined on the provided maps.

### **Current Policy (Adopted in 2017)**

Approximate Village Cost +/- \$25,000/yr

- All Snowfall Events - Village clears Village owned properties, roundabouts, and school sidewalk routes.
- 3" or Greater – Village clears all other sidewalk. Less than 3" abutting property owner responsible for the clearing of the sidewalk.
- Abutting Property owners must maintain sidewalk free of snow and ice after initial clearing efforts by the Village. Residents have 48 hours after a snowstorm to complete sidewalk shoveling
- Village at its discretion, may provide additional sidewalk clearing of County and State Highway sidewalk.

### **Staff Recommended Sidewalk Clearing Ordinance**

(Continuous Improvement Committee Recommendation with Exception of Problem Area Sidewalk)

Approximate Village Cost +/- \$25,000/yr

- All Snowfall Events – Village clears Village owned properties, roundabouts, and problem area sidewalk (Riverside Dr., Webster Ave., Allouez Ave and Brookridge St.).
- 6" or Greater – Village clears all other sidewalk. Less than 6" abutting property owner responsible for the clearing of the sidewalk.

Regardless of the selected option above, adjacent property owner required to keep sidewalk clear of snow and ice after Village sidewalk snowplowing. Residents have 48 hours after a snowstorm to complete sidewalk shoveling.



## Sidewalk Snow Removal Comparison by Municipality

### Village of Allouez Sidewalk Snow Removal:

Municipality	Time Allotted	Who's Responsible
Village of Allouez	48 Hours	Owner of Property

### Brown County:

Municipality	Time Allotted	Who's Responsible
City of Green Bay	24 Hours	Occupant / Owner of Parcel
City of De Pere	48 Hours	Owner of Parcel
Village of Suamico	24 Hours	Occupant / Owner of Property
Village of Ashwaubenon	24 Hours	Occupant / Owner of Property
Village of Bellevue	48 Hours	Occupant / Owner of Parcel
Village of Wrightstown	24 Hours	Occupant / Owner of Parcel
Village of Denmark	Promptly	Occupant / Owner of Parcel
Town of Ledgeview	24 Hours	Occupant / Owner of Parcel

### Municipalities Outside of Brown County:

Municipality	Time Allotted	Who's Responsible
City of Chilton	36 Hours	Owner of Lot
Village of Coloma	Not Specified	Occupant / Owner of Lot
City of Wauwatosa	Immediately After Snowfall	Occupant / Owner of Lot
Village of Potosi	24 Hours	Occupant / Owner of Lot
City of Oconomowoc	Promptly	Occupant / Owner of Lot
City of Manitowoc	Snow fallen by 6 a.m. must be removed by 8 p.m. the same day.	Occupant / Owner of Parcel
City of Darlington	24 Hours	Occupant / Owner of Lot



## Liability FAQ 1

**If a municipal ordinance requires property owners to remove snow and ice from sidewalks abutting their property, are the property owners then liable for injuries which result from a failure to remove snow or ice from a sidewalk?**

No. Although a municipality can by ordinance require property owners to remove snow and ice from sidewalks abutting their property, the long-standing rule in Wisconsin is that maintenance of a municipal sidewalk is a non-delegable duty and therefore, the municipality rather than the landowner is responsible for injuries caused by traveling on a snowy or icy municipal sidewalk. See *McCoats v. Threshermen's Mutual Ins. Co.*, Case No. 96-0715 (Ct. App. Jan 14, 1997, unpublished), citing *Walley v. Patake*, 271 Wis. 530, 540, 74 N.W.2d 130, 135 (1956) and *Hagerty v. Village of Bruce*, 82 Wis.2d 208, 213-14, 262 N.W.2d 102, 104 (1978).

Section 66.0907(5) and (10) require the board of public works or other municipal officers designated to handle street or sidewalk matters to "keep the sidewalks ... clear of snow and ice in all cases where the owners or occupants of abutting lots fail to do so ...." Thus, it is ultimately the municipality's responsibility. However, municipalities are afforded some protection by Wis. Stat. sec. 893.83, which prohibits an action for damages for injuries sustained because of a natural snow or ice accumulation unless the accumulation existed for three weeks. Section 893.83 also makes clear that actions for damages caused by accumulation of snow or ice existing more than 3 weeks are subject to sec. 893.80 which affords municipalities immunity for discretionary decisions and limits damages. If a resident fails to remove snow and ice as required by ordinance, that resident is subject to a forfeiture if the ordinance imposes one, and the municipality can perform the work itself and charge the property owner for the removal as a special charge under sec. 66.0627 or as a special tax under sec. 66.0907(5).



